

Map: Route Plan (please highlight your route)

 - Recommended Route  
 (S) - Staging Area  
 SEES

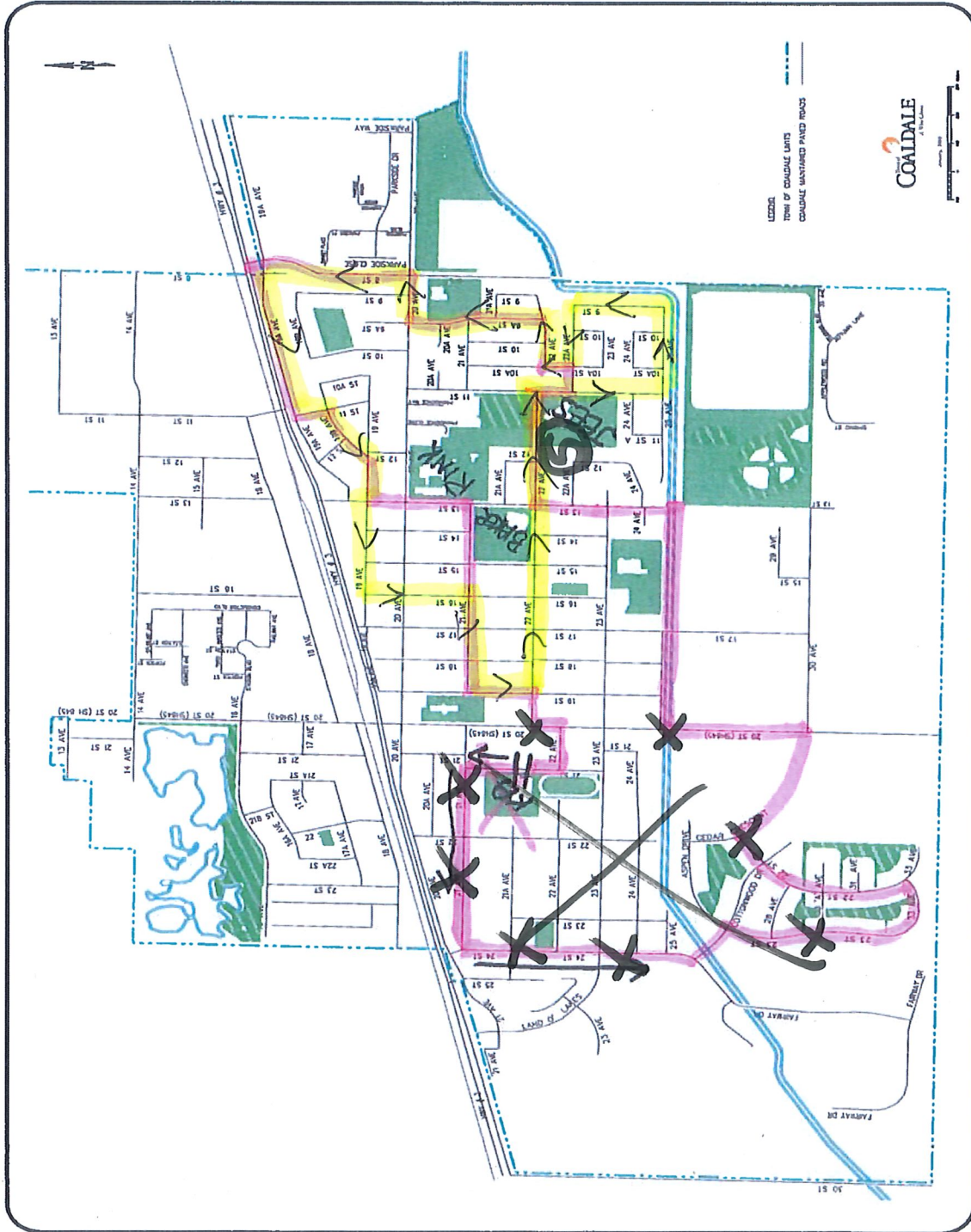

**Submit Application to:** Town of Coaldale, Community Services Department  
 1306- 20 St, Coaldale AB, Phone: (403)345-1324 [commserv@coaldale.ca](mailto:commserv@coaldale.ca)